

REVISIONS				
REV	DATE	DESCRIPTION	ECN	BY
A		REDESIGNED HAND BRAKE, CRP	7847	
B	04-14-2008	ADDED 34562	8260	MMM

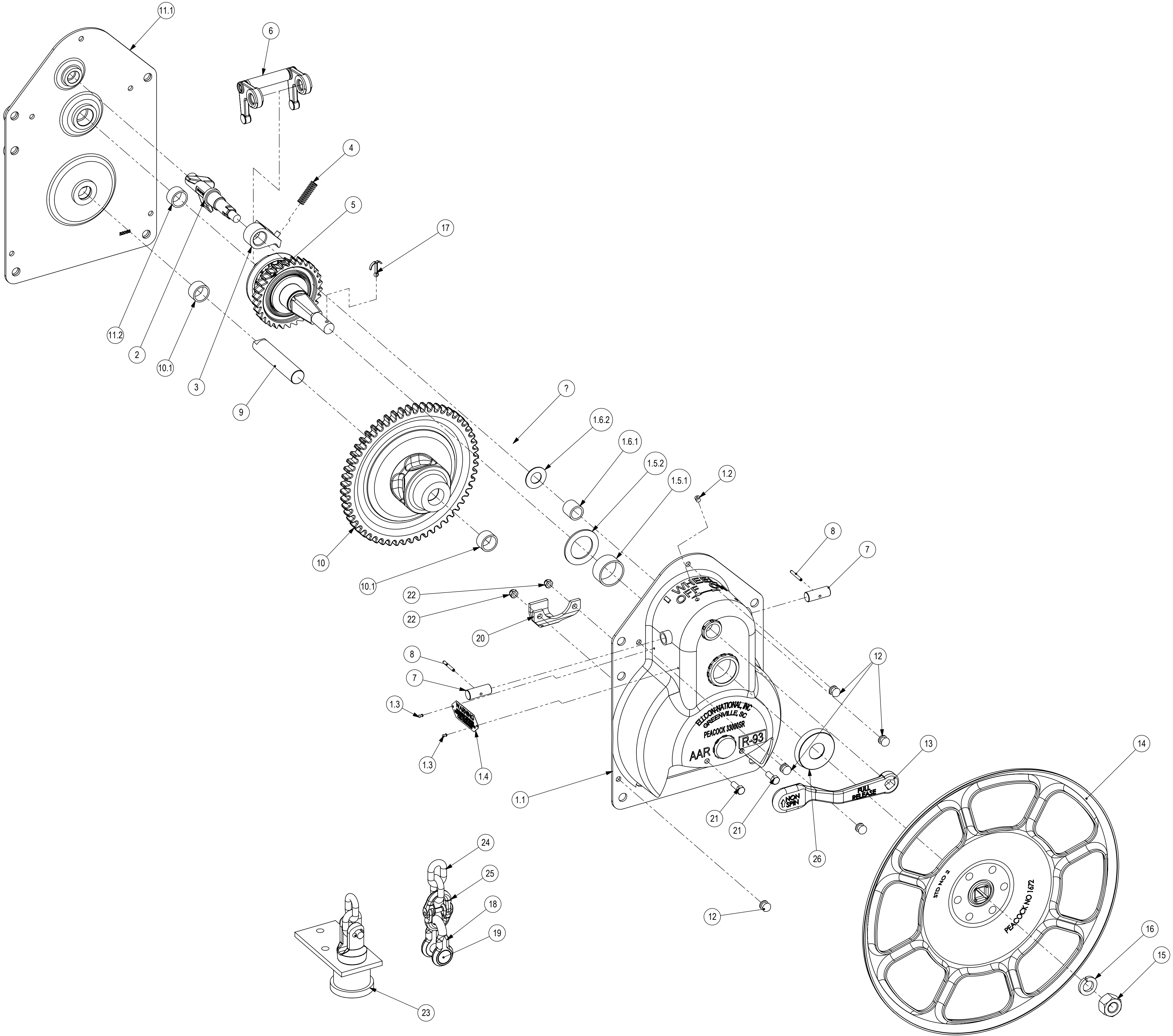

SEE DWG D-33000SR FOR ASSEMBLY OF PARTS

26	34562	RUBBER DEFLECTOR	1
25	32234	COUPLING LINK	1
24	32157	CHAIN	1
23	7360	SHOCK RETARDER	1
22	4493-8	NUT	2
21	998-A	SCREW - 3/8-16 X 1	2
20	30693	PRESSED STRIPPER	1
19	240	RIVET	1
18	458	CLEVIS	1
17	4034-9	COTTER PIN	1
16	242	LOCK WASHER	1
15	241	NUT	1
14	1672	HAND WHEEL	1
13	32275	TRIP LEVER	1
12	454	RIVET	5
11.2	32071	BEARING	1
11.1	32058	BACK PLATE	1
11	32102	BACKPLATE ASSEMBLY	1
10.1	32071	BEARING	2
10	32172	CHAIN GEAR	1
9	32069	GEAR SHAFT	1
8	1664	ROLL PIN	2
7	9236	YOKE SHAFT	2
6	4622	YOKE ASSEMBLY	1
5	32082-3	PINION ASSEMBLY	1
4	32075	PAWL SPRING	1
3	35148	COMBINATION PAWL	1
2	9143-2	CAM SHAFT	1
1.6.2	32231-3	FRONT PAWL SHAFT THRUST BEARING	1
1.6.1	32231-4	FRONT PAWL SHAFT BEARING	1
1.6	32231	FRONT PAWL SHAFT BEARING	1
1.5.2	32074-3	BEARING WASHER	1
1.5.1	32074-4	BEARING	1
1.5	32074	PINION BEARING	1
1.4	31818	WARNING LABEL	1
1.3	3338-1	RIVET	2
1.2	5892	OIL CUP	1
1.1	32072	HOUSING	1
1	35352	HOUSING ASSEMBLY	1
ITEM NO.	Part No	DESCRIPTION	QTY.

BILL OF MATERIAL

INTERPRET DRAWING IN ACCORDANCE WITH ASME Y14.5 ALL DIMENSIONS ARE IN INCHES UNLESS NOTED TOLERANCES/FINISHES UNLESS OTHERWISE NOTED DECIMALS .XX ± FRACTIONS XX ± ANGLES ± DRILLED HOLE DIAMETERS +.010/-01 BREAK ALL SHARP CORNERS AND EDGES CHECK ALL TAPPED HOLES 1/8" X ONE THREAD DEEP MATERIAL				EST. WT. LBS
NEXT ASSEMBLY CUSTOMER		USED ON VENDOR		APPROVAL CODE
ELLCON NATIONAL 50 BEECHREE BLVD. GREENVILLE, S.C. 29605		IDENTIFICATION CHART MODEL 33000SR BRAKE		
DRAWN MMM	CHECKED DATE 8/29/2005	SCALE 1:1	SHEET 1 OF 1	
DX 33000SR		B		

THIS DOCUMENT AND ITS CONTENTS ARE THE PROPERTY OF ELLCONATIONAL, INC. AND ALL RIGHTS ARE RESERVED. NO PART OF THIS DOCUMENT IS TO BE REPRODUCED OR TRANSMITTED IN ANY FORM OR BY ANY MEANS, ELECTRONIC OR MECHANICAL, INCLUDING PHOTOCOPYING, RECORDING, OR BY ANY INFORMATION STORAGE AND RETRIEVAL SYSTEM, WITHOUT THE WRITTEN PERMISSION OF ELLCONATIONAL, INC.