

REVISIONS				
REV	DATE	DESCRIPTION	ECN	BY
A		REDESIGNED HAND BRAKE, CRP	7847	
B	04-11-2008	ADDED 34562	8260	MMM

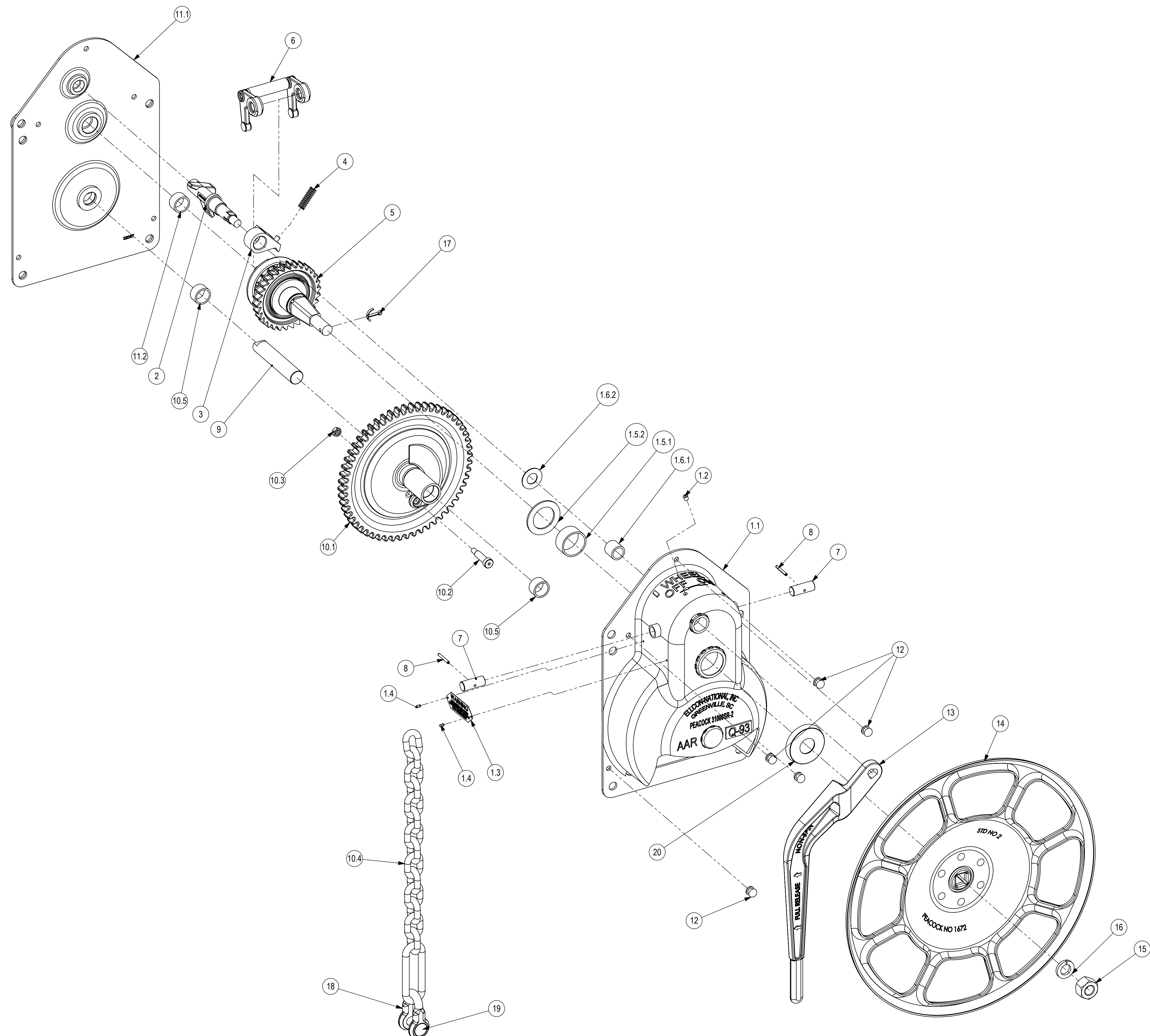

SEE DRAWING D-31000SR-2 FOR ASSEMBLY OF PARTS

ITEM NO.	PART No	DESCRIPTION	QTY.
20	34562	RUBBER DEFLECTOR	1
19	240	RIVET	1
18	458	CLEVIS	1
17	4034-9	COTTER PIN	1
16	242	LOCK WASHER	1
15	241	NUT	1
14	1672	HAND WHEEL	1
13	3107	TRIP LEVER	1
12	454	RIVET	5
11.2	32071	BEARING	1
11.1	32067	BACK PLATE ASSEMBLY	1
11	32095	BACK PLATE ASSEMBLY	1
10.5	32071	BEARING	2
10.4	32096	CHAIN ASSEMBLY	1
10.3	3443-53	HEX NUT	1
10.2	5340-4	SHOULDER BOLT	1
10.1	32173	GEAR & CHAIN DRUM ASSEMBLY	1
10	32159	CHAIN DRUM ASSEMBLY	1
9	32069	GEAR SHAFT	1
8	1664	ROLL PIN	2
7	9236	YOKE SHAFT	2
6	4622	YOKE ASSEMBLY	1
5	32082-3	PINION ASSEMBLY	1
4	32075	PAWL SPRING	1
3	35148	COMBINATION PAWL	1
2	9143	CAM SHAFT	1
1.6.2	32231-3	FRONT PAWL SHAFT THRUST BEARING	1
1.6.1	32231-4	FRONT PAWL SHAFT BEARING	1
1.6	32231	FRONT PAWL SHAFT BEARING	1
1.5.2	32074-3	BEARING WASHER	1
1.5.1	32074-4	BEARING	1
1.5	32074	PINION BEARING	1
1.4	3338-1	RIVET	2
1.3	31818	WARNING LABEL	1
1.2	5892	OIL CUP	1
1.1	32068	PRESSED STEEL HOUSING	1
1	35351	HOUSING ASSEMBLY	1
1		DESCRIPTION	QTY.

ELLCON NATIONAL  
50 BEECHER BLVD. GREENVILLE, S.C. 29605

### IDENTIFICATION CHART MODEL 31000SR-2

DATE: 8/29/2005 SCALE: 1:1  
DRAWN: MMM CHECKED: [ ]  
SHEET 1 OF 1 REV B

DX 31000SR-2

INTERPRET DRAWING IN ACCORDANCE WITH ASME Y14.5	THIRD ANGLE PROJECTION
TOLERANCES/FINISHES UNLESS OTHERWISE NOTED	
DECIMALS: .XX ±	MACHINED SURFACES
FRACTIONS: XXX ±	DRILLED HOLE DIAMETERS +.010/-01
ANGLES: 1	BREAK ALL SHARP CORNERS AND EDGES
	CHK ALL TAPPED HOLES 1/8" X ONE THREAD DEEP
	MATERIAL
EST. WT: 90 LBS	
NEXT ASSEMBLY	USED ON
CUSTOMER	VENDOR
WEB	APPROVAL CODE

THIS DOCUMENT AND ITS CONTENTS ARE UNCLASSIFIED UNLESS INDICATED OTHERWISE. ANY INFORMATION CONTAINED HEREIN IS UNCLASSIFIED EXCEPT WHERE SHOWN OTHERWISE. THIS DOCUMENT IS UNCLASSIFIED.