

REVISIONS				
REV	DATE	DESCRIPTION	ECN	BY
B				
E	04-22-2008	REDRAWN, ADDED 34562	8260	MMM

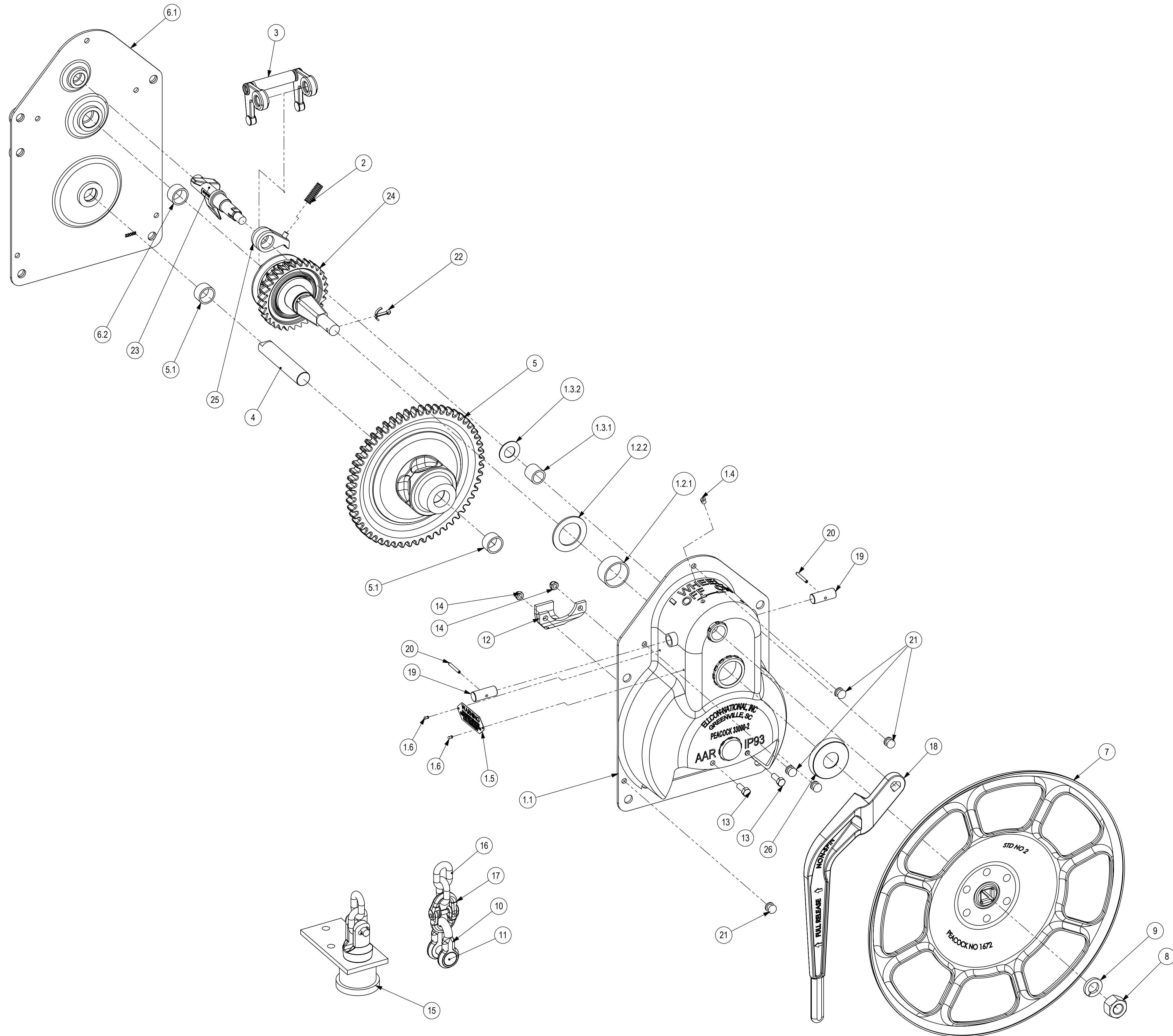

SEE DWG D-33000-2 FOR ASSEMBLY OF PARTS

ITEM NO.	Part No	DESCRIPTION	QTY.
26	34562	RUBBER DEFLECTOR	1
25	4092	HOLDING PAWL	1
24	32082	PINION ASSEMBLY	1
23	9143	CAM SHAFT	1
22	4034-9	COTTER PIN	1
21	454	RIVET	5
20	1664	ROLL PIN	2
19	9236	YOKE SHAFT	2
18	3107	TRIP LEVER	1
17	32234	COUPLING LINK	1
16	32157	CHAIN	1
15	7360	SHOCK RETARDER	1
14	4493-8	NUT	2
13	998-A	SCREW - 3/8-16 X 1	2
12	30693	PRESSED STRIPPER	1
11	240	RIVET	1
10	458	CLEVIS	1
9	242	LOCK WASHER	1
8	241	NUT	1
7	1672	HAND WHEEL	1
6.2	32071	BEARING	1
6.1	32058	BACK PLATE	1
6	32102	BACKPLATE ASSEMBLY	1
5.1	32071	BEARING	2
5	32172	CHAIN GEAR	1
4	32069	GEAR SHAFT	1
3	4622	YOKE ASSEMBLY	1
2	32075	PAWL SPRING	1
1.6	3338-1	RIVET	2
1.5	31818	WARNING LABEL	1
1.4	5892	OIL CUP	1
1.3.2	32231-3	FRONT PAWL SHAFT THRUST BEARING	1
1.3.1	32231-4	FRONT PAWL SHAFT BEARING	1
1.3	32231	FRONT PAWL SHAFT BEARING	1
1.2.2	32074-3	BEARING WASHER	1
1.2.1	32074-4	BEARING	1
1.2	32074	PINION BEARING	1
1.1	32072	HOUSING ASSEMBLY	1
1	32103	HOUSING ASSEMBLY	1

BILL OF MATERIAL

INTERPRET DRAWING IN ACCORDANCE WITH ASME Y14.5 ALL DIMENSIONS ARE IN INCHES UNLESS NOTED TOLERANCES/FINISHES UNLESS OTHERWISE NOTED DECIMALS: .xx ± FRACTIONS: xxx ± ANGLES: ° DRILLED HOLE DIAMETERS +.010/-01 BREAK ALL SHARP CORNERS AND EDGES CHECK ALL TAPPED HOLES: 1/8" X ONE THREAD DEEP MATERIAL EST. WT. LBS.		THIRD ANGLE PROJECTION MACHINED SURFACES	
NEXT ASSEMBLY EN CODES CUSTOMER		USED ON VENDOR APPROVAL CODE	
DRAWN: MMM CHECKED: RLC DATE: 6-2-92 SCALE: 1:1 SHEET: 1 OF 1 REV: E		ELLCON NATIONAL 50 BEECHTREE BLVD. GREENVILLE, S.C. 29605 IDENTIFICATION CHART MODEL 33000-2 BRAKE	
DX 33000-2		1 E	

THIS DOCUMENT AND ITS CONTENTS ARE CONFIDENTIAL AND PROPRIETARY INFORMATION OWNED BY ELLCORPORATIONAL, INC. AND IS TO BE RETURNED TO ELLCORPORATIONAL, INC. AND ALL COPIES HEREOF ARE TO BE RETURNED TO ELLCORPORATIONAL, INC. UNLESS OTHERWISE SPECIFIED. THE INFORMATION CONTAINED HEREIN IS UNCLASSIFIED.