

REVISIONS				
REV	DATE	DESCRIPTION	ECN	BY
-		DB		
E	04-07-2008	REDRAWN, ADDED 34562	8260	MMM

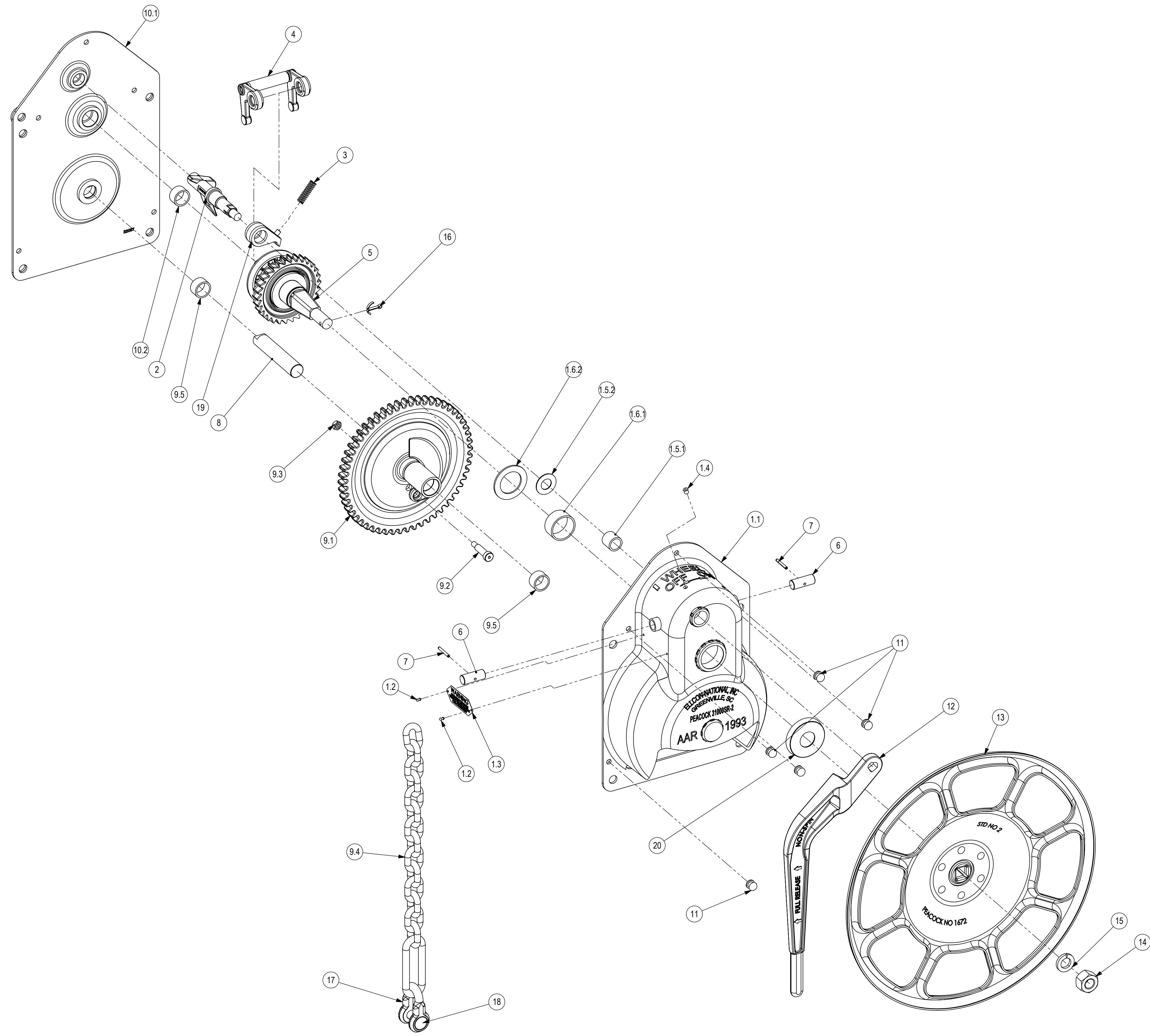

SEE DRAWING D-31000-2 FOR ASSEMBLY OF PARTS

ITEM NO.	PART NUMBER	DESCRIPTION	QTY.
20	34562	RUBBER DEFLECTOR	1
19	4092	HOLDING PAWL	1
18	240	RIVET	1
17	458	CLEVIS	1
16	4034-9	COTTER PIN	1
15	242	LOCK WASHER	1
14	241	NUT	1
13	1672	HAND WHEEL	1
12	3107	TRIP LEVER	1
11	454	RIVET	5
10.2	32071	BEARING	1
10.1	32067	BACK PLATE ASSEMBLY	1
10	32095	BACK PLATE ASSEMBLY	1
9.5	32071	BEARING	2
9.4	32096	CHAIN ASSEMBLY	1
9.3	3443-53	HEX NUT	1
9.2	5340-4	SHOULDER BOLT	1
9.1	32173	GEAR & CHAIN DRUM ASSEMBLY	1
9	32159	CHAIN DRUM ASSEMBLY	1
8	32069	GEAR SHAFT	1
7	1664	ROLL PIN	2
6	9236	YOKE SHAFT	2
5	32082	PINION ASSEMBLY	1
4	4622	YOKE ASSEMBLY	1
3	32075	PAWL SPRING	1
2	9143	CAM SHAFT	1
1.6.2	32074-3	BEARING WASHER	1
1.6.1	32074-4	BEARING	1
1.6	32074	PINION BEARING	1
1.5.2	32231-3	FRONT PAWL SHAFT THRUST BEARING	1
1.5.1	32231-4	FRONT PAWL SHAFT BEARING	1
1.5	32231	FRONT PAWL SHAFT BEARING	1
1.4	5892	OIL CUP	1
1.3	31818	WARNING LABEL	1
1.2	3338-1	RIVET	2
1.1	32068	PRESSED STEEL HOUSING	1
1	32083	HOUSING	1

BILL OF MATERIAL

INTERPRET DRAWING IN ACCORDANCE WITH ASME Y14.5 THIRD ANGLE PROJECTION ALL DIMENSIONS ARE IN INCHES UNLESS NOTED TOLERANCES/FINISHES UNLESS OTHERWISE NOTED DECIMALS: .XX ± FRACTIONS: XXX ± ANGLES: 1 DRILLED HOLE DIAMETERS +.010/-01 BREAK ALL SHARP CORNERS AND EDGES CHAMFER ALL TAPPED HOLES 1:8 X ONE THREAD DEEP MATERIAL: EST. WT: 92 LBS			
<b>IDENTIFICATION CHART</b> <b>MODEL 31000-2</b>			
NEXT ASSEMBLY CUSTOMER: Y WEB: Y	USED ON VENDOR: H APPROVAL CODE: A.T.	DRAWN: MMM CHECKED: RLC DATE: 6-3-92 SCALE: 1:4	SHEET: 1 OF 1 REV: E

THIS DOCUMENT AND ITS CONTENTS ARE CONFIDENTIAL AND PROPRIETARY INFORMATION OWNED BY ELLCON NATIONAL, INC. AND ALL RIGHTS ARE RESERVED. IT IS TO BE RETURNED TO ELLCON NATIONAL, INC. IMMEDIATELY UPON REQUEST. THE DISCLOSURE OF ANY PART HEREIN SHALL BE CONSIDERED A BREACH OF CONFIDENTIALITY AND PROPRIETARY INFORMATION. THE INFORMATION CONTAINED HEREIN IS THE PROPERTY OF ELLCON NATIONAL, INC. AND IS NOT TO BE REPRODUCED OR TRANSMITTED IN ANY FORM OR BY ANY MEANS, ELECTRONIC OR MECHANICAL, INCLUDING PHOTOCOPYING, RECORDING, OR BY ANY INFORMATION STORAGE AND RETRIEVAL SYSTEM.